

Project Name:	Notes:	Date:	Type:
---------------	--------	-------	-------

DESCRIPTION

The HBT Highbay fixture is efficient, durable, light weight and designed to withstand harsh conditions with its remarkable heat dissipation, dust-tight body, and resistance to water. Available with aluminum or polycarbonate reflector.

Ideal for gymnasiums, warehouses, retail spaces, and convention centers.



CONSTRUCTION

Fin design, raised circular driver, and advanced aluminum heat sink provides superb thermal transfer to extend component life. Fixture comes standard with hook for suspension mount. U-bracket for direct mounting optional.

ELECTRICAL

Luminaire is built with the highest quality universal 100-277VAC drivers (custom order available for 347-480VAC driver).

ENERGY SAVINGS

Replaces 250W metal halide high bay, reducing energy consumption by approximately 75%.

OPTICAL SYSTEM

Designed to reduce glare and improve light distribution.

SENSOR READY

Motion sensor and daylight harvesting ready.

DIMMING

1-10V dimmable standard

CERTIFICATION

UL Listed, FCC, RoHS, CE, DLC Premium Listed on QPL, IP65 Rated for Wet Location

TECHNICAL SPECIFICATION

WATTAGE	200W
LUMENS	26,558 lumens
EFFICACY	131 lm/W
VOLTAGE	AC100-277V (347-480V custom order)
POWER FREQUENCY	50/60 Hz
CCT	5000K (other CCT custom order)
CRI	Ra>80
BEAM ANGLE	110° standard
WORKING TEMP.	-40°F - +122°F
STORAGE TEMP.	-40°F - +158°F
IP RATING	IP65 Wet Location
DIMMABLE	1-10V dimming
POWER FACTOR	>0.9
THD	≤15%
WARRANTY	5 year limited
PORTOR CAT#	PT-HBT-200W-5K



MODEL NUMBER(S)

MODEL#	WATTS	LUMENS	LM/WATT	CCT	CRI	VOLTAGE
UF010-100W-110-H-50K	100W	13,018	132	5000K	>80	AC 100/277V
UF010-150W-110-H-50K	150W	19,665	131	5000K	>80	AC 100/277V
UF010-200W-110-H-50K	200W	26,558	131	5000K	>80	AC 100/277V
UF010-240W-110-H-50K	240W	32,017	131	5000K	>80	AC 100/277V
UF010-300W-110-H-50K	300W	39,678	131	5000K	>80	AC 100/277V

Project Name:	Notes:	Date:	Type:
---------------	--------	-------	-------

DIMENSION

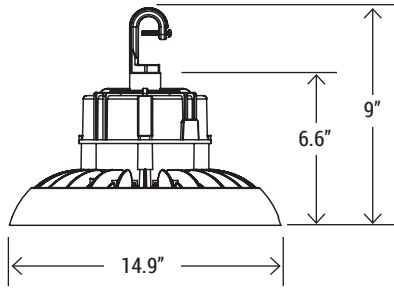

Hook Mount

MOUNTING OPTION



PT-HBT-A-UB
U-Bracket Mounting

REFLECTORS



PT-HBT-RL-AL
Aluminum Reflector for use with
200W and 240W HBT Round
High bay
(Dia: 23" x Height: 5.5")



PT-HBT-RL-PC
Polycarbonate Reflector or use
with 200W and 240W HBT Round
High bay
(Dia: 18.75" x Height: 8")

AVAILABLE OPTION



PT-A-MSH-C
Motion Sensor

PHOTOMETRY

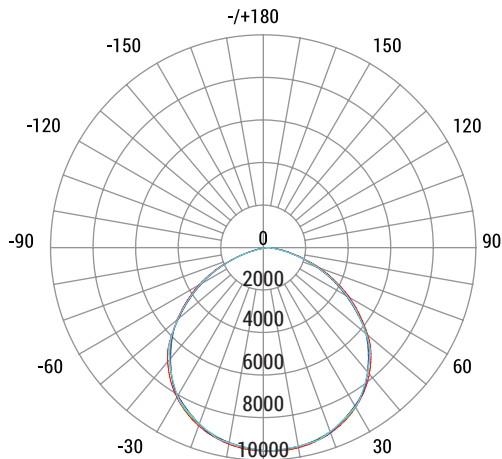

UNIT: cd
 — C0/180, 112.2
 — C30/210, 110.5
 — C0/240, 110.5
 — C30/270, 111.1

Average Beam Angle (50%) : 111.1 degree