

Catalog Number:	Project Name:	Note:	Date:	Type:
-----------------	---------------	-------	-------	-------

The LS1 series is a slim, light weight and energy efficient luminaire that is equipped with 0-10V dimming capability and a field-adjustable CCT and wattage selector.

The fixture includes standard surface mounting kit excellent for utility applications such as parking garage, warehouse, hallway, storage facility, restrooms and stairwell.



CONSTRUCTION

The luminaire features matte white finish and galvanized housing. T-bar mounting hole make it easy for installation, and multiple knock-outs provide options for occupancy sensor.

OPTICAL SYSTEM

Luminaire is built with the highest quality driver that is Universal Voltage (120V-277V), uses long lasting, high-efficient LED package.

LENS

Frosted lens diffuser reduces glare and improves overall light output.

SENSOR READY

Motion sensor and daylight harvesting sensor available, for factory installation.

ENERGY SAVINGS

Over 50% energy savings than traditionally fluorescent fixtures, low heat productions requires less maintenance and operation cost.

LISTING

UL Listed, DLC Premium Listed

LIFESPAN

L70 >100,000 hours

WARRANTY

5 year Limited Warranty

WATTAGE	DELIVERED LUMENS	EFFICACY
2' 15W/20W/25W	3,561	150 lm/W
4' 25W/30W/40W	5,240	132 lm/W
8' 55W/60W/65W	8,515	132 lm/W

Based on the highest wattage @ 4000K default setting, 80 CRI. Actual lumens may vary.

TECHNICAL SPECIFICATION

CCT	3500K/4000K/5000K
CRI	80+
DIMMABLE	0-10V dimming
VOLTAGE	120V-277V
POWER FREQUENCY	50/60 Hz
POWER FACTOR	>0.9
THD	≤10%
WORKING TEMPERATURE	-40°F ~ 122°F
STORAGE TEMPERATURE	-40°F ~ 158°F
IP RATING	IP44, Suitable for damp locations
WARRANTY	5 year limited



ORDERING SAMPLE: - - - - -

Series	Size	CCT/Wattage
PT-LS1 LED Linear Strip Luminaire	2FT (2-footer)	3CP (3500K/4000K/5000K) (15W/20W/25W)
	4FT (4-footer)	3CP (3500K/4000K/5000K) (25W/30W/40W)
	8FT (8-footer)	3CP (3500K/4000K/5000K) (55W/60W/65W)

Accessories/Options		
EM Battery	Sensor	Mounting
___ Blank PT-EMN-08W-050 PT-EMN-15W-050	___ Blank PT-UNI2-SP-PR ELB-UNI (Required) MSH-RC2 PT-UNI-35-NDP ELB-UNI-35 (Required) MSS-RC-100	___ Blank (Standard surface mount) A-CBL WG-LS1-4F CON-LS1

Catalog Number:	Project Name:	Note:	Date:	Type:
-----------------	---------------	-------	-------	-------

DIMENSION

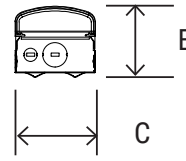
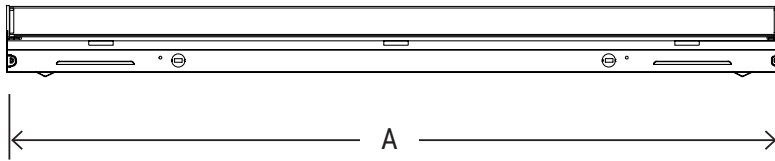

QTY/BOX

6

DIMENSION	PT-LS1-8FT	PT-LS1-4FT	PT-LS1-2FT
A	94.2"	47.3"	22.2"
B	2.52"	2.52"	2.52"
C	2.83"	2.83"	2.83"

CCT AND WATTAGE SELECTOR

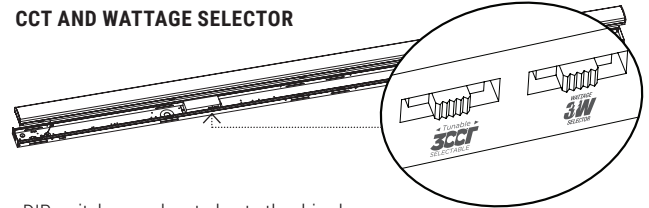

- DIP switches are located onto the drive box.
- Select a wattage and color temperature by sliding switch left or right respectively to the desired value.

MOUNTING OPTION



SM
Surface mount (Standard)
Comes with junction cover



A-CBL
Hanging wire for
strip light

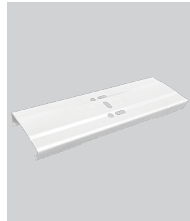

CON-LS1
Connector

WIRE GUARD OPTION

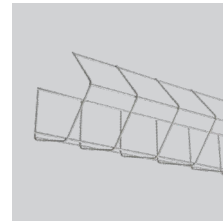

WG-LS1-4F
Wire guard for 4-ft LS1

(For 8-ft fixtures,
two WG-LS1-4F are needed)

EM BATTERY OPTION



PT-EMN-08W-050 (4FT)
PT-EMN-15W-050 (8FT)
LED Emergency Driver

SENSOR OPTION



PT-UNI2-SP-PR
Dimmable PIR
Motion Sensor
with Daylight
Harvesting



ELB-UNI
Elbow for
UNI2-SP-PR
(Required)



MSH-RC2
Intelligent
Control Unit



PT-UNI-35-NDP
Dimmable PIR
Motion Sensor



ELB-UNI-35
Elbow for
UNI-35-NDP
(Required)



MSS-RC-100
Intelligent
Control Unit